

## TECHNICAL SHEET 05.06.20-EN

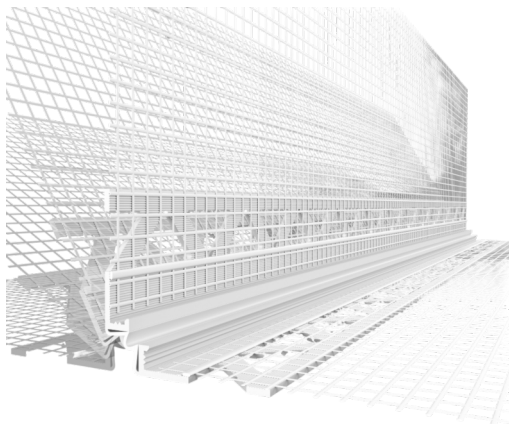

# JUBIZOL Movement joint bead mini

## Movement joint bead mini

### 1. Description, usability

JUBIZOL DILETATION PROFILE MINI is intended for making angular or straight mini expansion joints in JUBIZOL thermal insulation systems. It provides elastic connection between two different surfaces.

Features:

- elastic connection of adjacent areas
- universal construction for both corners and straight sections
- expansion joint protection against weather effects
- prevention of humidity penetration under the insulation layer
- profile edge allowing for easy and aesthetic plaster finish

### 2. Packaging

- JUBIZOL DILETATION PROFILE MINI (piece 2.5 m, cardboard 62.5 m)

### 3. Technical data

Product name	JUBIZOL DILETATION PROFILE MINI
Material	Hard PVC and soft PVC - resistant to alkalis and UV Glass fiber mesh in accordance with ETAG 004
Batten lenght	2500 mm
Mesh width	100 mm
Thickness of thin-layer coatings	6 mm
Movement area	±8/ +7, -5
Mesh attachment method	Fastening with a plastic stick (resistant to alkalis and temperature changes)

## 4. Installation

Apply a base coat of mortar to the edges of the JUBIZOL DILETATION PROFILE MINI profile. Place the expansion joint profile and press it onto the mortar, leveling it with a spirit level. Then press the mesh onto the mortar. Remove excess mortar on the outer side of the mesh and level it with a trowel. Once the base coat of mortar has dried, apply the reinforced base coat and the following layers. Remove the protective tape until the render starts to harden.

The width and position of the expansion joint should be determined separately for each project. The recommended gap width for the use with this product is 10 mm.

For the display of the profile, see picture 001 in the appendix.

## 5. Instructions for safe use of the product

Safety handling instructions, first aid measures, fire protection measures, measures in case of accidental releases, special storage instructions, required personal protective equipment, waste handling instructions, special transport requirements, and other legally prescribed information are provided in the product's safety data sheet. In addition to these instructions, it is necessary to follow the guidelines and regulations for safety in construction, facade work, and painting when installing the product.

## 6. Storage, transportation conditions and durability

Packed in cardboard boxes. Store in a dry and covered area at a temperature of +5°C to +40°C. Transport in a horizontal position. Shelf life when stored in the original sealed and undamaged packaging: at least months.

## 7. Other information

The technical instructions in this brochure are provided on the basis of JUB's experience and are given as a guideline for achieving the optimum results. JUB cannot accept any responsibility for the damage caused by incorrect selection of a product, incorrect use or unprofessional work.

Safety measures: Follow the instructions on the safety data sheet of the product.

This technical sheet supplements and replaces all preceding editions. JUB reserves the right to change and supplement data in the future.

Designation and date of issue: TDS 136/25-pek, 15.12.2025

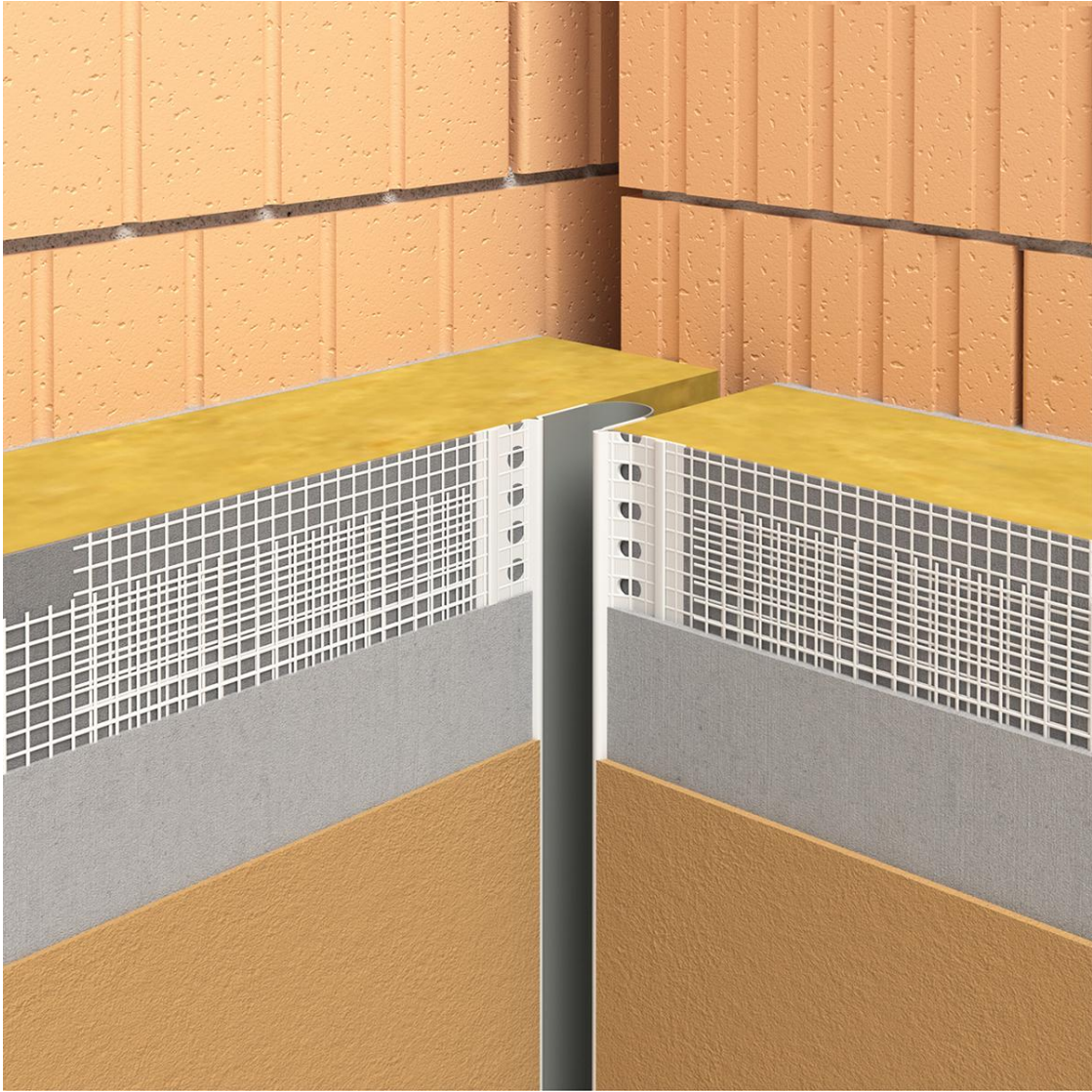

001